

# POWERPACK SE SERIES

## 6/10 kVA

1:1  
PHASE

### ONLINE UPS



HOME/OFFICE



EMERGENCY



MEDICAL



INDUSTRY



DATA CENTER



TRANSPORT



UPS ONLINE



TOWER



POWER FACTOR



SERVICE



## FEATURES

- High Frequency and True Double-Conversion
- DSP (Digital Signal Processors) Technology
- Input Power Factor Correction (PFC)
- Wide Input Voltage Range (110~300V)
- Output Power Factor 0.9
- Cold Start
- Auto Sensing Frequency
- ECO Mode Operation for Energy Saving
- Selectable Output Voltage via LCD
- 50Hz/60Hz Frequency Converter Mode Available
- Selectable Battery Low Voltage via LCD
- Power-On Self Test
- Advanced Battery Management (ABM)
- Short Circuit and Overload Protection
- Automatically Charging Battery at UPS Off Mode
- Fan Speed Auto Control when Load Varies
- Generator Compatible
- Standard RS232 Communication Port
- USB/SNMP Communication Port (Optional)
- Emergency Power Off (EPO) (Optional)
- Extension Battery Bank (Optional)
- Manual Bypass
- N+X Redundancy Parallel (Optional)

## DETAILS

1. Input-Output Terminal
2. Input Breaker
3. Battery Breaker
4. Maintenance Switch
5. Fan
6. Battery Temperature Sensor
7. Parallel Card (Optional)
8. EPO
9. RS232
10. USB (Optional)
11. SNMP/AS400 (Optional)
12. BAT\_NTC (Optional)

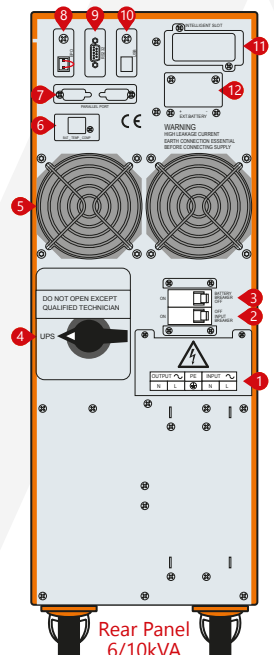

Rear Panel  
6/10kVA



POWER  
FORLIFE

**Aytemiz**  
MAKELSAN®  
Uninterruptible Power Supplies

MODEL			
Power Watt		<b>6kVA / 5400W</b>	<b>10kVA / 9000W</b>
<b>INPUT</b>			
Related Voltage	208V / 220V / 230V / 240 VAC		
Voltage Range	Half Load (110-300) ±5 VAC, Full Load (160-300) ±5 VAC		
Frequency	40 ~ 70 Hz (Auto Sensing)		
Power Factor	≥0.99		
Bypass Voltage Range	160V - Rated Output Voltage +32V		
<b>OUTPUT</b>			
Voltage Range	208V / 220V / 230V / 240 VAC (Setting Available via LCD)		
Voltage Regulation	±1%		
Frequency	45 ~ 55 Hz or 55 ~ 65 Hz (Synchronized Range); 50 / 60 Hz ±0.1 Hz (Battery Mode)		
Waveform	Pure Sine Wave		
Crest Factor	3:1		
Harmonic Distortion	≤2% (Linear Load); ≤5% (Non-Linear Load)		
Transfer Time	AC Mode to Battery Mode: 0ms Inverter Mode to Bypass Mode: 0ms		
Overload Capability	105% ~ 125%: Transfer to Bypass after 3min 125% ~ 150%: Transfer to Bypass after 30sec >150%: Transfer to Bypass after 100ms		
<b>EFFICIENCY</b>			
AC Mode	≥92%		
Battery Mode	≥91%		
ECO Mode	≥98%		
<b>BATTERIES</b>			
DC Voltage	192V-240V		
Inbuilt Battery	16-20 x 7-9Ah		
Charge Current	Standard Model	3.5A	
	Long Time Model	1A / 3.5A / 7A	
Typical Recharge Time	8 hours Recover to 90% Capacity		
<b>ALARMS</b>			
Utility Failure	Beep / 4sec		
Low Battery	Beep / 1sec		
Overload	Beep Twice / 1sec		
UPS Fault	Long Beep		
<b>ENVIRONMENTAL</b>			
Humidity	20-90% RH @ 0-40°C (Non-Condensing)		
Noise Level	≤50 dB (1m)		
<b>COMMUNICATION</b>			
RS232 (Standard) / USB (Optional)	Supports Windows® 98/2000/2003/XP/Vista/2008/Windows® 7/8/10		
SNMP (Optional)	Power Management from SNMP Manager and Web Browser		
<b>DIMENSIONS &amp; WEIGHT</b>		<b>6kVA</b>	<b>10kVA</b>
Dimensions WxDxH (mm)	262 x 650 x 735		
Packaging Dimensions WxDxH (mm)	440 x 720 x 940		
Net Weight (kg)	64.1	70.8	
Gross Weight (kg)	72.2	78.9	

Aytemiz-Makelsan reserves the right to change or modify product design, construction, specifications, or materials without prior notice and without incurring any obligation to make such changes and modifications on Aytemiz-Makelsan products previously or subsequently sold. Aytemiz-Makelsan does not guarantee the items of the accuracy and completeness.